



Manual backpack sprayer with 12 and 16 litre capacity respectively, with a fibreglass lance and a wear-resistant polyacetal nozzle. Sprayer suitable for use in large gardens.



Advantages

- Lightweight fibreglass lance.
- It includes a mixer to ensure the homogeneity of the mixing of the treatment.
- Adjustable padded straps.
- Homogeneous treatment thanks to the pressure regulator.
- Lever fastening to make transportation easier.
- Ambidextrous and lightweight keeping the ergonomics.



Functional information



3-position pressure regulator



Lance/lever support



Chamber with synthetic seal for intensive use

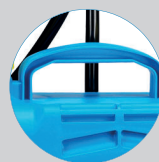

Integrated and comfortable transport handle



Fibreglass lance



Large filling opening



Adjustable padded straps



Side level indicator

Technical information

Technical information	SUPER GREEN 12	SUPER GREEN 16
HOSE	1.3 m (PVC)	
STANDARD NOZZLES	Adjustable conical	
LANCE	Fibreglass (71 cm)	
USEFUL CAPACITY	12 L	16 L
TOTAL CAPACITY	12.6 L - 3.33 US Gals	16.8 L - 4.50 US Gals
LITRES/MIN. 1,5 BAR	0.43 l/min	
LITRES/MIN. 3 BAR	0.6 l/min	
NET WEIGHT	3.16 Kgs - 6.95 Lbs	3.26 Kgs - 7.17 Lbs
WIDE FILLER OPENING	YES	
SET OF NOZZLES FOR HERBICIDE AND INSECTICIDE TREATMENTS	YES	
STANDARD ACCESSORIES	Pressure regulator, set of nozzles (herbicide elbow plus fan, mirror and disc nozzles), two seals (1 rubber and 1 synthetic) and a dispenser	
LANCE AND EXTENSIONS	Lance/Lever	
STRAPS	Adjustable and padded	
CHAMBER SEAL	Synthetic	
PRESSURE REGULATOR	YES (3 positions)	
HANDLE	PP	

Logistics data

Logistics data	SUPER GREEN 12	SUPER GREEN 16
CODE	8.39.49	8.39.47
EAN	84.14685.20050.1	84.14685.20033.4
CONDITIONING	1 unit	
UNITS PER PALLET	18 units	
DIMENSIONS PER PALLET	1200 X 800 X 1180	

MAINTENANCE KITS



PR MAINTENANCE KIT
Reference 8.39.41.870
Keep your sprayer at peak performance. Designed for 12-20 L sprayers.

ROUND SEAL AN-8 No. 101	2.23.15.908	
STAINLESS STEEL BALL Ø 12 No. 119	2.20.08.902	
VITON SEAL No. 120	8.39.11.305	
ROUND SEAL AN-5 No. 136	2.23.15.905	
CHAMBER VALVE No. 365	8.39.41.303	
FILTER WASHER No. 1034	8.49.41.410	



ACCESSORIES

Personalize your sprayer adapting it to your application needs (height, hard-to-reach areas...)



3.2 M TELESCOPIC LANCE
Reference 8.35.40.913
5.4 M TELESCOPIC LANCE
Reference 8.35.40.915



4-HOLE NOZZLE
Reference 8.34.46.801

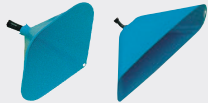

CONICAL HOOD
Reference 8.34.40.870
RECTANGULAR HOOD
Reference 8.34.40.871



QUADRUPLE BOOM
Reference 8.34.60.870



DOUBLE ADJUSTABLE NOZZLE
Reference 8.34.46.802



PRESSURE REGULATOR (EVOLUTION - AGRO GREEN TYPE)
Reference 8.35.47.870



ANTI-DRIFT NOZZLE (INDUCED AIR) 80°
Reference 8.34.46.814
ANTI-DRIFT NOZZLE (INDUCED AIR) 120°
Reference 8.34.46.804



LOW-VOLUME WEED-KILLERS ELBOW
Reference 8.34.60.935



1 M FIBREGLASS LANCE TUBE WITH COMPLETE ELBOW
Reference 8.34.60.873
1.5 M FIBREGLASS LANCE TUBE WITH COMPLETE ELBOW
Reference 8.34.60.874

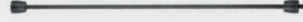

1 M ALUMINIUM LANCE TUBE WITH COMPLETE ELBOW
Reference 8.34.60.871
1.5 M ALUMINIUM LANCE TUBE WITH COMPLETE ELBOW
Reference 8.34.60.872



EXTENSION 0.5M
Reference 8.35.40.870
FLEXIBLE DOUBLE NOZZLE
Reference 8.35.40.871



NOZZLE SET
Reference 8.34.46.870



TELESCOPIC EXTENSION Reference 8.35.40.876

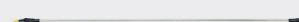

EXTENDIBLE DOUBLE NOZZLE
Reference 8.35.40.872



NORMAL WEED-KILLERS ELBOW
Reference 8.34.60.934

SPARE PARTS

Extend the service life of your sprayer easily replacing parts.

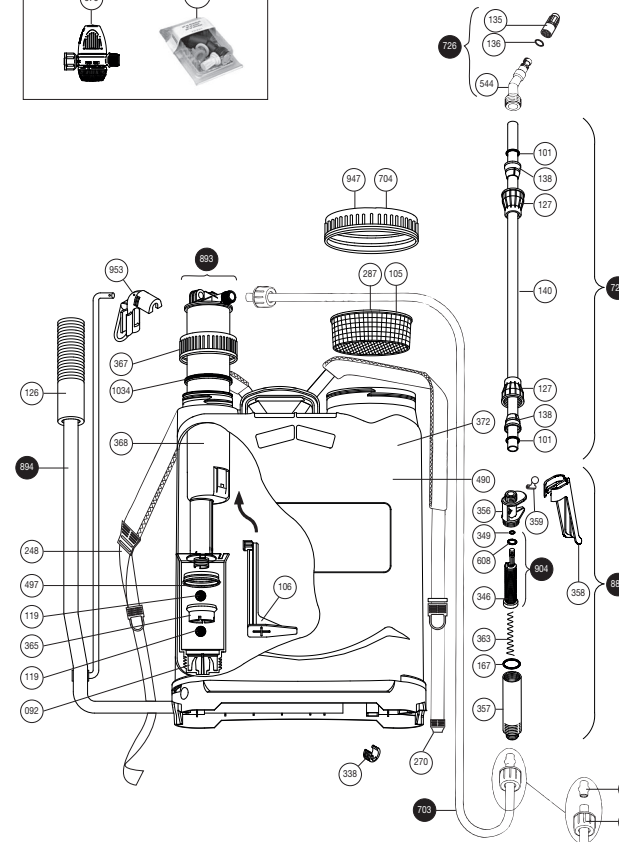
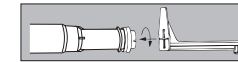
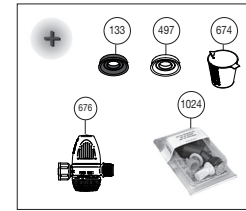

N.	COD.	Q	SPARE PARTS NAME
92	8.39.41.603	1	CYLINDER WITH BALL
101	2.23.15.908	2	ROUND GASKET AN-8
105	8.39.18.303	1	TANK FILTER 16 L.
106	8.39.47.306	1	AGITATOR
119	2.20.08.902	2	STAINLESS STEEL BALL Ø 12
126	8.39.43.304.1	1	GRIP
127	8.38.12.323	2	CONE NUT
133	8.39.09.306	1	RUBBER SEAL
135	8.39.02.323	1	NOZZLE Ø 1
136	2.23.15.905	1	ROUND GASKET AN-5
138	8.38.12.328	2	Ø 10 CONE
140	8.39.18.427	1	Ø TO TUBE
167	2.23.15.914	1	ROUND GASKET AN-14
248	8.39.41.364	1	STRAP
270	8.39.41.365	1	STRAP WITH HOOK
287	8.39.06.303	1	TANK FILTER 12 L.
290	8.38.08.308	2	HOSE BUSHING
291	8.42.02.332	2	NUT
338	8.39.43.327	1	BASE BUSHING
346	8.39.47.365	1	LANCE FILTER
349	2.23.16.903	1	ROUND GASKET AN-3
356	8.39.46.366	1	HANDLE BODY
357	8.39.46.367	1	GRIP
358	8.39.46.368	1	BLACK GRIP
359	8.39.46.369	1	HOOKING
363	8.39.41.342	1	FILTER SPRING
365	8.39.41.303	1	SEALING VALVE
367	8.39.47.308	1	GUIDE LID
368	8.39.41.302	1	PRESSURE CHAMBER
372	8.39.47.850	1	16 L. TANK
490	8.39.49.850	1	12 L. TANK
497	8.39.41.305	2	OPAQUE SYNTHETIC SEAL
544	8.28.40.322	1	SPRAYER
608	2.23.16.906	1	ROUND GASKET AN-6
674	8.39.41.350	1	100 ML DOSER
676	8.34.47.900	1	PRESSURE REGULATOR
703	8.39.18.805	1	COMPLETE HOSE
704	8.39.47.602	1	TANK COVER AND VALVE 16 L.
726	8.38.08.803	1	ELBOW WITH NOZZLE
727	8.39.18.627	1	TUBE WITH NUTS
883	8.39.41.801	1	COMPLETE HANDLE
885	8.39.46.823	1	COMPLETE LANCE
893	8.39.41.814	1	COMPLETE CHAMBER
894	8.39.41.802	1	COMPLETE LEVER
904	8.39.47.811	1	FILTER WITH GASKET
947	8.39.49.602	1	TANK COVER AND VALVE 12 L.
953	8.39.41.811	1	LANCE HOOK
1024	8.34.46.815	1	NOZZLES SET
1034	8.49.41.410	1	LOCKING WASHER
	8.39.47.200	1	INSTRUCTION SHEET
	8.39.49.201	1	SUPER GREEN 12 PACKAGING
	8.39.47.201	1	SUPER GREEN 16 PACKAGING